



AMAR  

PRAKRITI

PRITHVI | TEJAS | VAYU | JAL | AKASH



Actual drone shot, Amar Prakriti

Amar Prakriti is a development nestled at the foothills of Sahyadri. It is very close to Pune's iconic getaways like the Sinhagad fort and Khadakwasala backwaters.

Coupled with all the modern lifestyle amenities that you can cherish forever, Amar Prakriti offers you a lifetime opportunity to own your own dream plot in the countryside.



Actual drone shot, Amar Prakriti

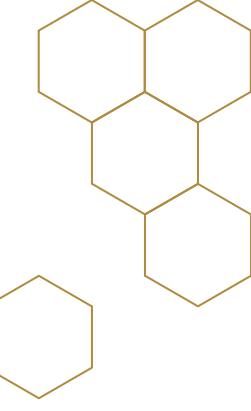

VISION

To use architectural, landscaping and technical excellence to create a blissful (Anandmay) experience amidst nature.

MISSION

To strike a healthy balance between the elements of nature and man made structures.
To provide amenities that nurture and rejuvenate both, the body and mind.
To connect all the residents closely to nature.

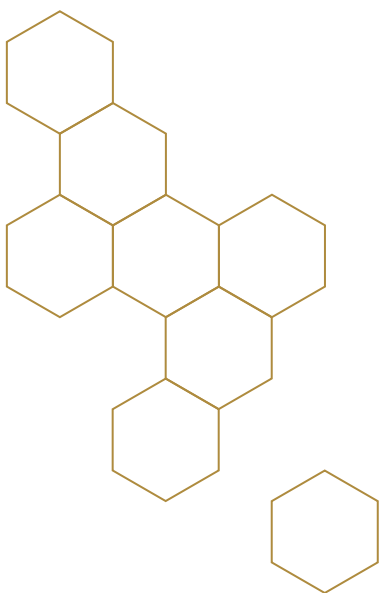



LOCATION

UNINTERRUPTED CONNECTIVITY
TO SCENIC RETREATS

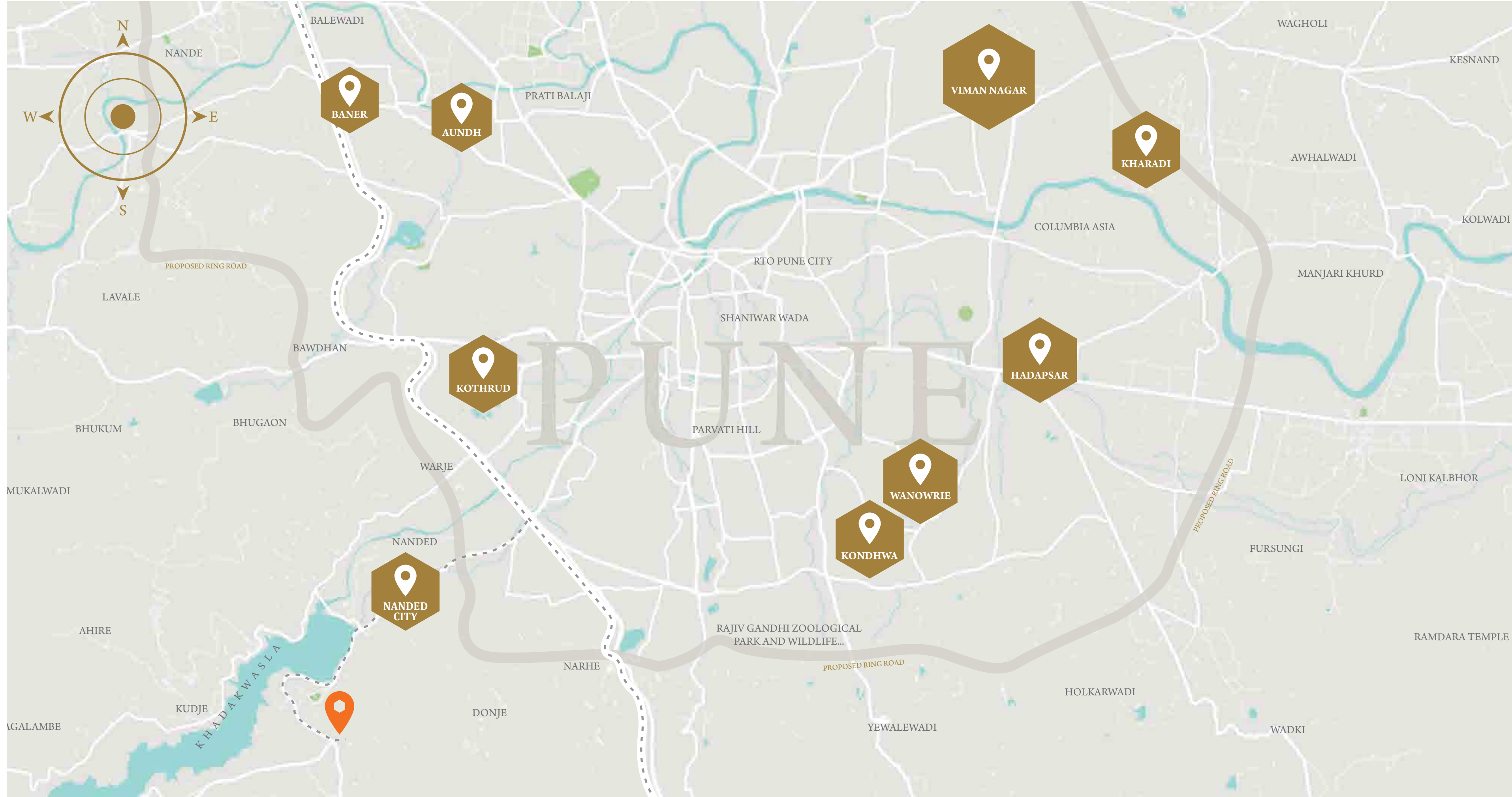

THE ENVIABLE GETAWAY THAT IS SO WELL CONNECTED

Nested in Donje, Amar Prakriti is conveniently accessible from various localities of Pune. Area such as Donje is a popular choice as it consists of properties with breathtaking views that also give you all the luxury of living in a premium residence in central Pune.

KEY DISTANCES	
Nanded City	9 Km.
Dhayari Phata	24 mins
Kothrud	40 mins
Baner	45 mins
Kondhwa	50 mins
Swargate	50 mins
Hadapsar	1 hr. 20 mins
Viman Nagar (Pune Airport)	1 hr. 30 mins

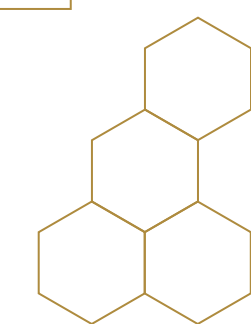
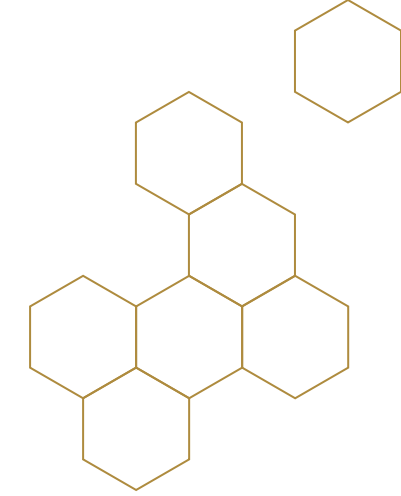



THE ENVIABLE GETAWAY THAT IS SO WELL CONNECTED

Away from the city surrounded by the concrete jungle, to add its leisures, Amar Prakriti is in close proximity to the lovely Khadakwasala dam, various resorts, and is quintessentially only a few minutes away from the scenic Sahyadri hills. Truly, Amar Prakriti is redefining what luxury means in today's reality.

KEY DISTANCES

Nanded City	9 Km.
Krushnai Water Park	5 Mins
Khadakwasla Dam	12 Mins
Sinhgad Fort	20 Mins
Pune-Bangalore Highway	24 Mins

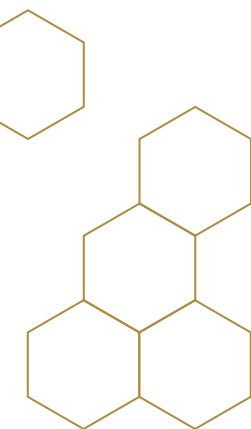
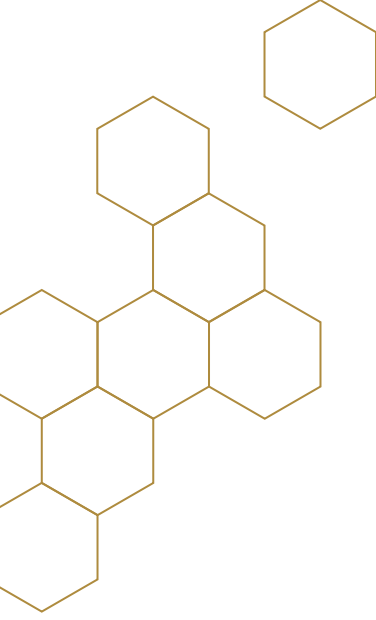



KHADAKWASLA BACKWATER

TO PUNE

TO SINHAGAD FORT

DONJE CHOWK

AMAR PRAKRITI

Actual drone shot of site

CONNECTED WITH CITY AND NATURE ALIKE

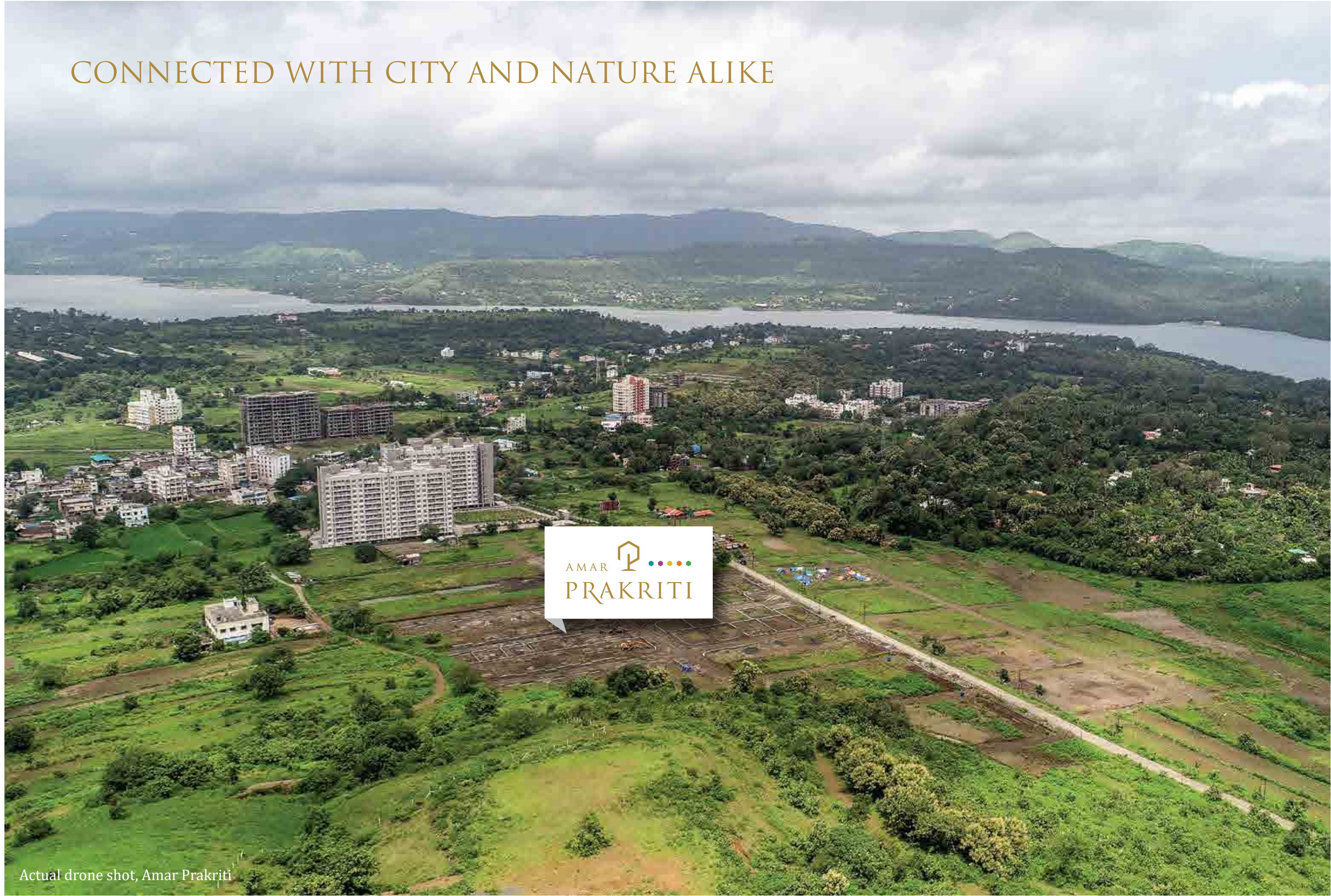

Actual drone shot, Amar Prakriti



Actual drone shot, Amar Prakriti



Actual drone shot, Amar Prakriti



CONCEPT

THE PERSPECTIVE OF
AMAR PRAKRITI

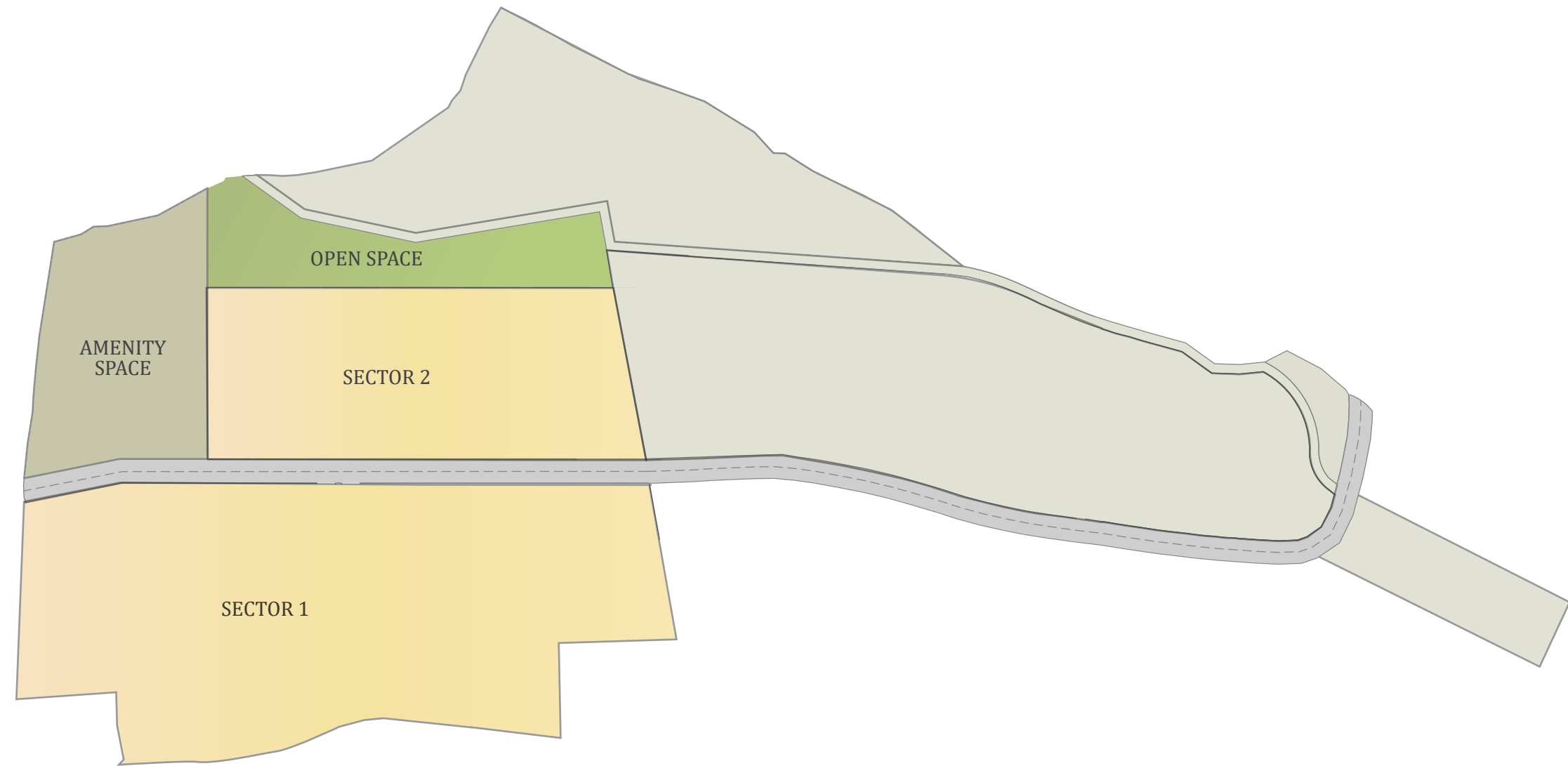

ROOTS OF OUR DESIGN PHILOSOPHY

At the core, Amar Prakriti is carved to life by integrating the 5 elements of nature with its landscape. These 5 elements create a balance between your mind, body, nature and lifestyle.

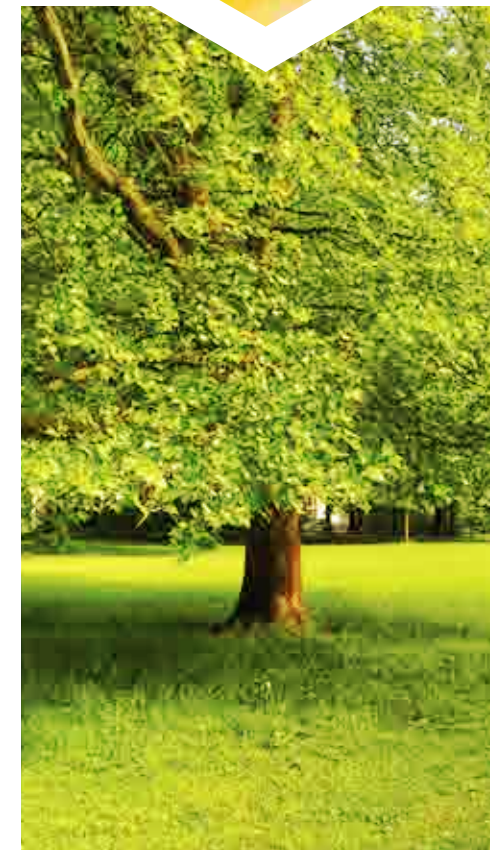

PRITHVI

The earth element that manifests stability in the mind and body and endows us with the power to withstand and endure.

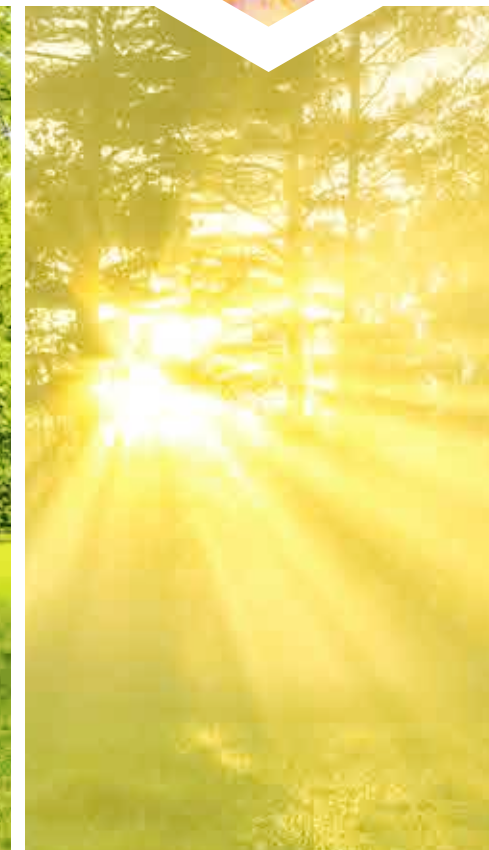

TEJAS

The fire element that appeals to the passion and energy within us and gives us the power to transform.



VAYU

The air element that mirrors our dynamic thoughts and its constant free motion to open your heart to the soul of nature.



JAL

The water element that channelises our eternal flow of feelings and emotions.



AKASH

The ether element that represents the space and substance. It helps us create a mind palace to meditate.



BOULEVARD AT AMAR PRAKRITI

*Artistic impression





PLANNING

PIECING TOGETHER
THE SPIRIT OF NATURE



MASTERCLASS OF A MASTERPLAN

The masterplan of Amar Prakriti reflects simplicity of design. Well laid out road networks that follow the text book grid pattern with properly designed crossroads and well landscaped peripheries are the hallmark of the layout.





AMENITIES

CHERISH THE SLICE
OF A GOOD LIFE

ENTRANCE OF AMAR PRAKRITI



*Artistic impression



AMENITIES THAT BREATHE LIFE INTO THE COMMUNITY

PROJECT AMENITIES

- Multipurpose hall
- Party lawn
- Half olympic size swimming pool with changing room
- Toddler / baby swimming pool
- Children's play area
- Multipurpose sports ground
- Jogging track



AMENITIES

This exquisitely-planned area gives you access to an unimaginable range of contemporary amenities that are in harmony with the nature.

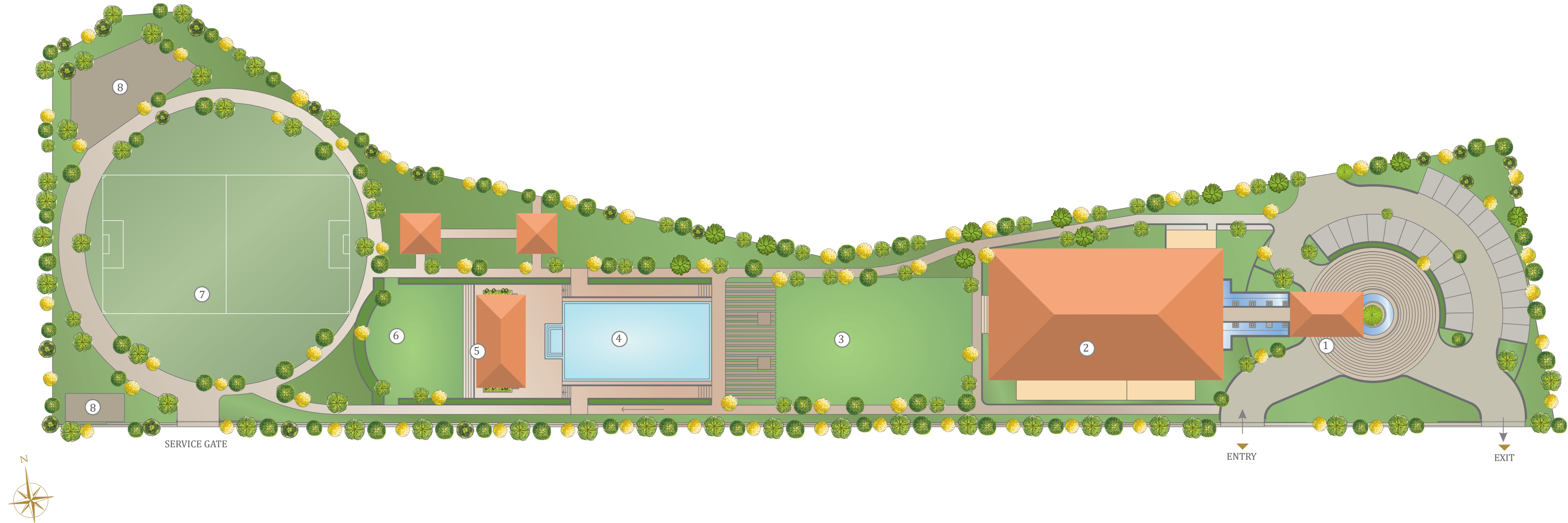

- ① ENTRANCE PORCH
- ② MULTIPURPOSE HALL
- ③ PARTY LAWN
- ④ SWIMMING POOL
- ⑤ CHANGING ROOMS
- ⑥ CHILDREN'S PLAY AREA
- ⑦ MULTIPURPOSE SPORTS GROUND
- ⑧ SERVICES

ENTRANCE PORCH



*Artistic impression

PORCH ENTRANCE



*Artistic impression



SWIMMING POOL

*Artistic impression





PARTY LAWN

*Artistic impression



MULTIPURPOSE SPORTS GROUND

*Artistic impression

CHILDREN'S PLAY AREA



*Artistic impression



MULTIPURPOSE HALL

*Artistic impression

The furniture shown is only for representation. No furniture will be provided by the Promoter.





TECHNICAL DETAILS

DISCOVER THE STATE-OF-THE-ART
FEATURES OF YOUR WOULD BE HOME



PROJECT SPECIFICATIONS

INTERNAL ROADS

- Internal roads finished in concrete and paver blocks over service lines
- LED street lights.
- Underground service grid infrastructure (Below paved area)

WATER

- Common Water Storage Reservoir for entire project (Including Future Proposed Phase 2).
- Pipe network from common water storage reservoir to individual plot.
- Water “tap-off” point at individual plot.

ELECTRICITY

- Common Transformer for entire project (Including Future Proposed Phase 2).
- Internal cable & feeder network infrastructure.
- Single cable run from source to each individual plot.
- 100% Generator back up for road lights and common areas.
- Total Load planned at 8 kw load (Three phase) for each individual plot.

DRAINAGE & STORM WATER

- Common Septic tank (Including Future Proposed Phase 2).
- Internal sewage network for drainage, from each plot till common septic tank.
- Storm water piped network infrastructure (along internal roads), with connection to rain water harvesting pits.
- Provision for installation of treatment plant over septic tank.

SECURITY

- 2 main entrance gates along with security cabin (Including Future Proposed Phase 2).
- 4 Emergency access gates (Including Future Proposed Phase 2).
- CCTV network for critical entry and exit points.
- External project compound wall of 6ft high in masonry.
- Individual Plot compound wall (with other adjoining plots) in 1 ft high masonry.

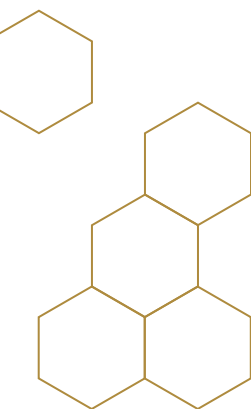
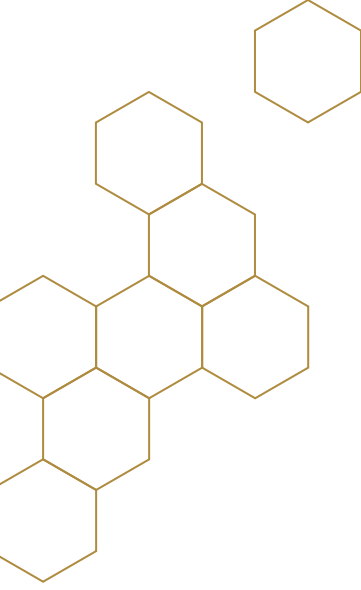



ABOUT THE TEAM

IDEATORS & CRAFTSMEN
BEHIND THE MASTERPIECE

HANDS THAT SHAPED AMAR PRAKRITI



PRITIKA MANJREKAR

PRINCIPAL ARCHITECT : MOCO DESIGN STUDIO

Moco design studio, an architecture and interior designing firm, was established in 2006 by Pritika Manjrekar with a modern approach towards architecture. The studio is influenced by cutting edge technology, sustainable design practices and the contemporary lifestyle. From working on five lakh square foot residential projects in Pune to designing custom homes, Moco Design Studio is successfully handling projects of varied scales. The distinguished portfolio of projects illustrates the firm's skill in combining innovative design with practical experience to meet client's expectations. Headquartered in Pune, Moco specializes in architectural designs providing full bouquet of services and specialized expertise to all commercial, institutional, high end residential, mass housing buildings, hospitals, educational institutes as well as designer custom homes. The firm has won many laurels which include the prestigious AESA Award, AICA Award and IIID Award for its projects.



MILIND CHAUDHARI

LIASONING ARCHITECT: MBC AND ASSOCIATES

M.B. Chaudhari and Associates is a team of Architects and Engineers, working with passion for design and excellence for more than 25 years. Over the years the team's design portfolio has spread across Residential complexes, Commercial Towers, IT Parks, Industrial Buildings, Hotels, Hospital, Bungalows and Malls. M.B Chaudhari has also been honoured with several awards for their work, including the coveted AESA awards.

Other than design & planning, the firm also has expertise in handling all liasoning work for big prestigious projects. The firm specialises in accommodating all the aesthetic and architectural requirements of project, within the given frame of local bye laws and regulations. It has been an honour to be associated with amar builders for past few decades. It is always an immense pleasure to work with team of amar builders along with other eminent colleague consultants throughout the project. We congratulate everyone associated with this project and wish a very happy stay to the residents.



MAHESH NAMPURKAR

LANDSCAPE DESIGN: SUMANSHILP

Ar. Mahesh Nampurkar, Partner "Suman Shilp" has been in the field of Architecture, Interior & landscape designing for past 25 years. In this tenure & journey for experience he has come across various challenges & milestones. He has worked on projects ranging from 5000 sq.ft. To 400 acers. He has been bestowed upon Ambience Award by Indian Express. He has been recognized with 5 Artist in Concrete Awards Asia for his contribution to space planning & aesthetics and AESA award for his work in the field of landscape. He has worked as a jury member for various competitions such as Kale Awards.

He is an associate member of Institute of Indian Interior designers, patron member of architects, engineers & surveyors associations. He is working as a member on Pune redevelopment forum which works for betterment & futuristic enhancement of the city.

In this tenure he had an opportunity to work with renowned architects such as Ar. Channa Daswate from Sri Lanka, Ar. Tadao Ando from Japan, Ar. Mario Botta from Italy on various projects.

With a strong and ambitious personnel headed beautifully by Mr. Mahesh Nampurkar and Mrs. Uma Nampurkar, we are all set to achieve exponential growth with collective experience and expertise of all the professionals associated with it.



ACHYUT WATVE

R.C.C. CONSULTANTS: JW CONSULTANTS

Started as a proprietary professional practice by Prof. Y. S. Sane in Pune and formerly known as Y S Sane Associates, JW Consultants LLP today is a well-known name for structural consultancy. Over the years they have been working with reputed construction companies across India as well as foreign countries like Sri Lanka, Nepal, Bhutan, Tanzania and Russia. While continually maintaining the superior quality standards in their work, JW Consultants LLP has also endeavoured to bring in the advantage of innovation into numerous projects, many thanks to their clients who showed the trust and offered their full support in implementing newer technologies. To support these work standards, they have state-of-the-art infrastructure in place. Internationally renowned softwares like STAAD PRO, ETABS, SAFE, ADAPT PT and BUILDER, RCC Design Center, STRUD, Tekla form the backbone of their design and drafting capabilities and stringent compliance with various national codes of practice such as Indian, European, British and American Codes lends a solid base to the theoretical fundamentals. Founded on the meticulously selected tenets of professional practice, JW Consultants LLP has created an impressive structure with projects spanning residential, commercial, industrial, retail, institutional, hospitality and healthcare sectors among others.



VINAYAK SANE

ELECTRICAL CONSULTANT: ABHIYANTA ELECTRICAL ENGINEERS

Established in 1991, situated in Pune, Abhiyanta Electrical Engineers and Consultants is amongst the leading proprietary firms offering outstanding Electrical Design Consultancy. Abhiyanta Consulting Engineers LLP has taken over the management and running of the business of "Abhiyanta" an ISO 9001: 2008 certified organization.

Beginning with few sq. ft. of area in its initial days to today's 200 lakh sq. ft. of area, Abhiyanta has been rolling out innovative electrical solutions for over three decades. By capitalizing on the extensive knowledge of codes and standards, and the latest technology, the firm's project designs perform smoothly from ideation to conception leading to an outstanding construction. The firm has effectively designed electrical services for some of the most prestigious residential, commercial, institutional, and industrial projects in and around Pune.

Over the years, the company has achieved various milestones of which the few are:

- Worked as consultants for M/s Irridium India Pvt. Ltd. for their Generic Gateway at Pune.
- Test facility for 100 MW Hydro & Turbo alternator at M/s CG ELIN Ltd. (now VA Tech) Plant at Mandideep.
- Completed successfully test bench for 4.5 MW Pump Set for M/s KSB Pumps Ltd, Pune.
- EON Campus, the largest ITES SEZ in Pune.
- Trump Towers, Pune.
- RITZ Carlton, Pune.
- Kirloskar Brothers, Corporate office, 1st Green Building in Pune.



NILESH GANDHI

PLUMBING CONSULTANT: ACE CONSULTANTS

Mr. Nilesh Gandhi is a Civil Engineer from MIT, Pune 1995 . He brings with him, rich experience gathered while working with some of the Prestigious companies in India. Ace Consultants is an entrepreneurial Venture started by Mr. Nilesh Gandhi in 2002 with a vision to provide efficient, optimized solutions in Design of Public Health Eng. & Fire Protection area. Ace Consultant has been in the field of Engineering Consultancy for PHE & FP For more than 18 years and has worked with several National & International client in the field of IT, Hotel, Commercial Mall & Offices, Residential, Institutional projects. The Company has Projects going on PAN India. Ace consultants have designed many Platinum, Gold rated LEED certified buildings as PHE & FP design consultant. The company adheres to all the Codes (both National and International) such as NBC, UIPC-I, NFPA (American) and FM Global, thus providing Customized services to all its Clients.





AMAR SERENITY, BANER



MANHATTAN, BANER



AMAR WESTVIEW, KOREGAON PARK



AMAR LANDMARK, BANER



AMAR ETERNITY, BANER



BOSTON, PRABHAT ROAD



“AS WE STRIVE TOWARDS EXCELLENCE, RECOGNITION BECOMES INEVITABLE.”

For more than 40 years Amar Builders has built a reputation for creating sound and stylish homes of uncompromising quality. We are a design conscious, creative and sustainable developer with a record of culturally successful and diverse projects.

Our attention to the impact of design on your daily life runs from the planning stages right through to the interior design and we are proud to set pivotal industry standards through our developments. As our homes are well planned, meticulously constructed and well appointed, they are easy to run and maintain. Each of our development has a timeless desirability that will last for years to come. With a finger right on the pulse of the latest research in architectural and lifestyle thinking, our focus is on building icons that embody innovation and progress, creating a strong legacy for future generations.



ASIA PACIFIC PROPERTY AWARDS



CNBC AWARD



AICA AWARD



AESA AWARD



READY PIUS AWARD



ABP AND ASTP, BANER



AMTP, BANER



ATP, BALEWADI



AP81, KOREGAON PARK



ATC, VIMAN NAGAR

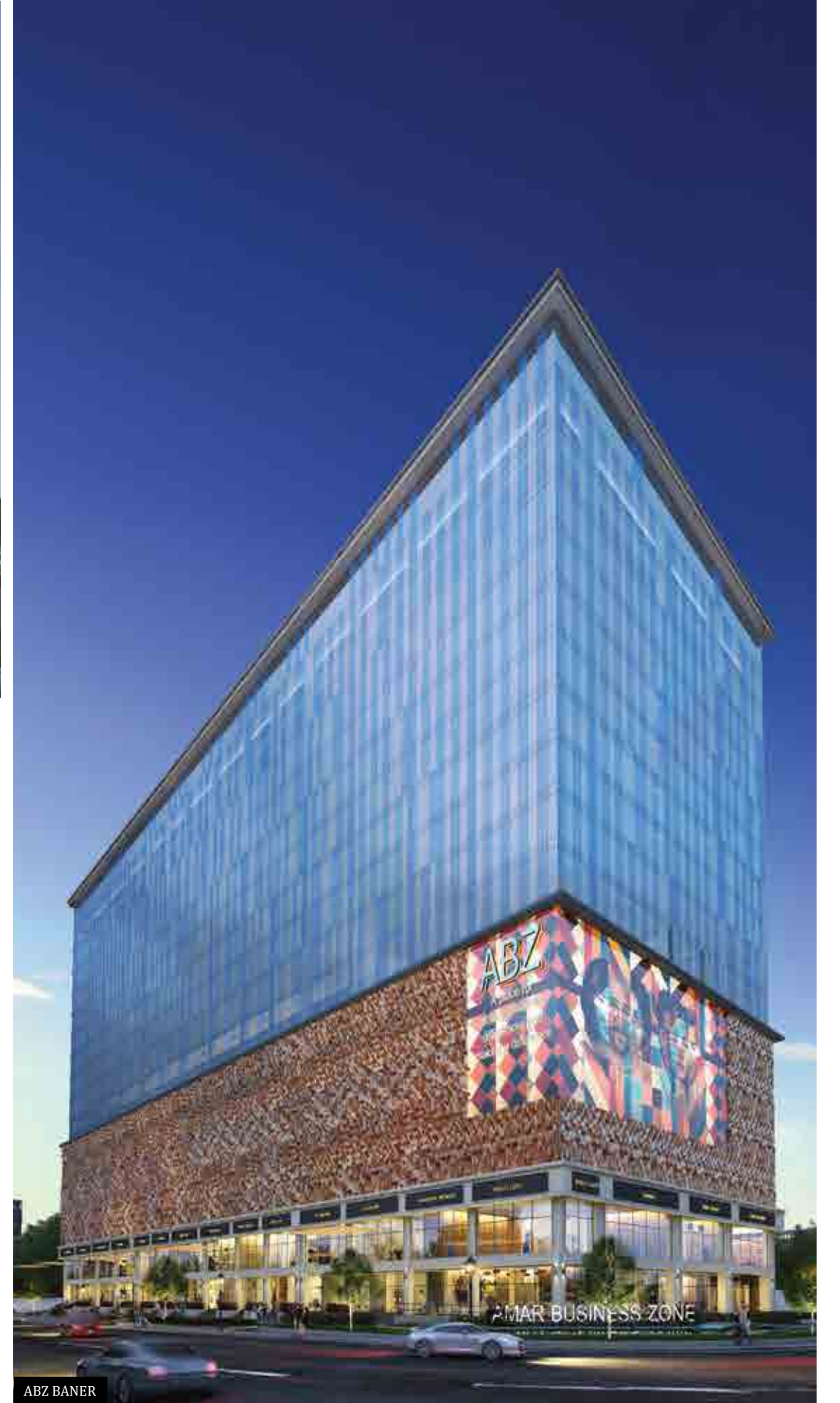

ABZ BANER



ACTUAL PHOTO



- KHADAKWASLA -



ACTUAL PHOTO



BHUGAON-PUNE



ACTUAL PHOTO

PRABHAVEE TECH PARK
BANER-PUNE



ARCHITECTURAL RENDITION



KARLA-LONAVALA



Prabhatee
GROUP

PIECE OF LAND FOR PEACE OF MIND

Prabhatee Group offers varied real estate solutions. With long-term approach to creating and cultivating new real estate options, Prabhatee ensures stronger relationships with all those who relate to their vision and become part of their projects.

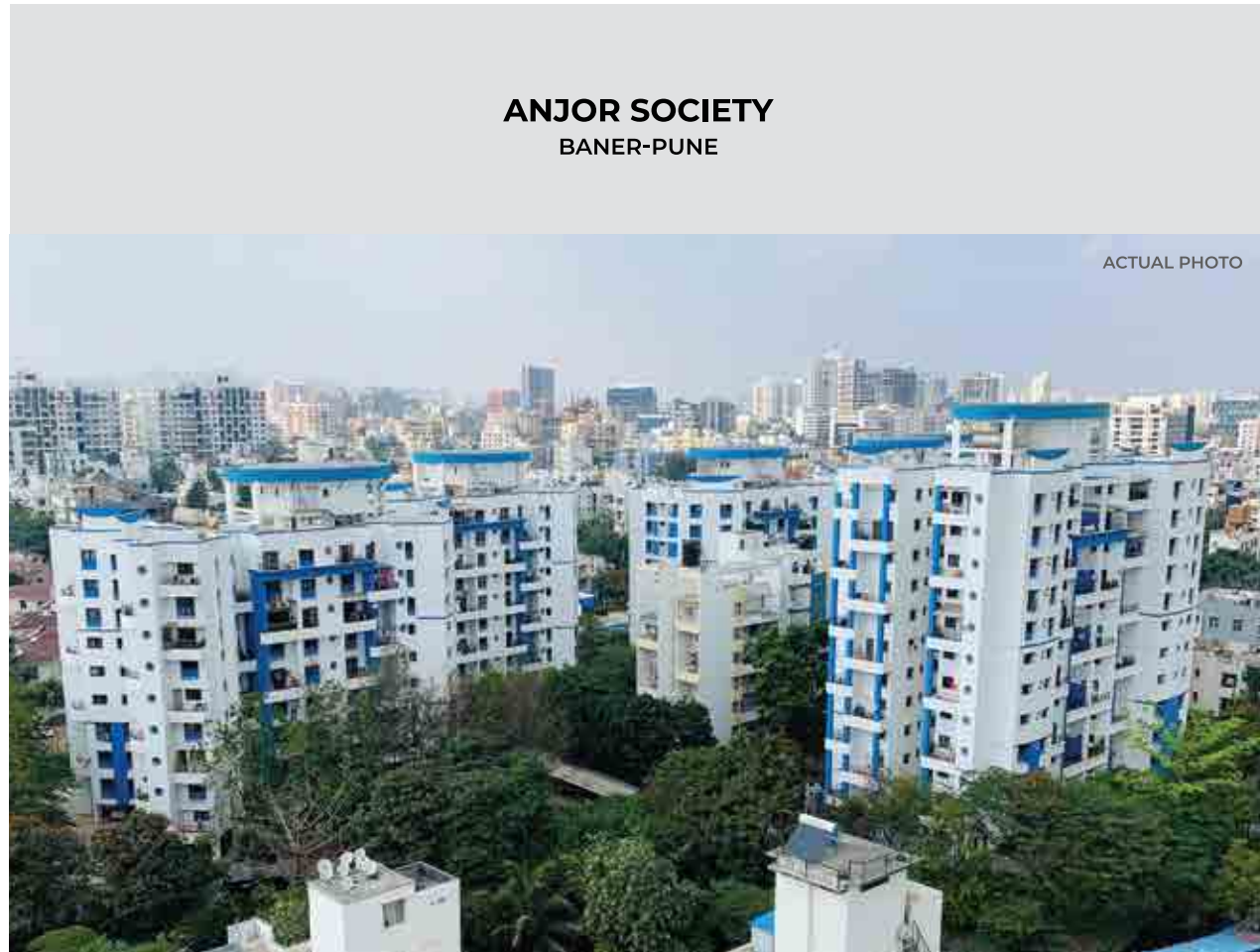

ANJOR SOCIETY
BANER-PUNE

ACTUAL PHOTO



VILLAS AT LONAWALA

ACTUAL PHOTO



SPIRITUAL SPACES

ARCHITECTURAL RENDITION

AMAR 
PRAKRITI

PROMOTER



CO-PROMOTERS

PARGE FAMILIES

ETERNITY BUILDCON LLP

Site Address: Amar Prakriti, Final Plot No.: Gat no 120/1 to 120/11 at Gorhe Bk., Haveli, Pune, 411025

Corporate Address: Amar House, 893, Lane No. 1, Off Bhandarkar Road, Near Goodluck Chowk, Deccan Gymkhana, Pune - 411 004

www.amarprakriti.com

The project has been registered via Maha RERA registration No.: **P52100030089** and is available on the website <https://maharera.mahaonline.gov.in/> under registered projects.

DISCLAIMER: All Rights Reserved: This brochure is purely conceptual and not a legal offering. The promotor reserves all the rights to add, delete, alter any detail, specifications, elevation mentioned herein. The brochure is indicative of how the furniture can be arranged in the residential unit. No furniture is to be supplied to the allottee by the promotor. All images, unless indicated are used for illustrative purpose only.

Media Consultants : Square One Media Solutions Pvt. Ltd.

